

In a nutshell: The advantages of topspeed.

What is topspeed?

topspeed stands for the rapid delivery of your ceilings. The range covers a selected group of ceiling panels with defined quotas, or maximum order volumes, for the Q-Clip, Q-L 107, R-H 200 and R-H 215 systems in colours RAL 9010 and partly in RAL 9006. The products are manufactured within five working days.

How do you place a topspeed order?

Firstly, check whether the product(s) you require at short notice indeed belong to the topspeed range. If the quantity you require lies within the quota, simply call Armstrong and enquire about availability. If your product falls within the topspeed criteria, you may place your order immediately.

How long will all of this take?

Provided that your technically-verified topspeed order reaches Armstrong at the latest by 09.00 hrs (CET) on Thursday, your order will be dispatched by Friday of the following week at the latest.

Are changes possible?

No. topspeed orders can unfortunately neither be amended or cancelled due to the short turnaround time.

How high are topspeed quotas?

Square tiles per week:

- max. 3000 m² unperforated or with Rg 2516 standard perforations
- max. 1500 m² with Rd 1522 or Rg 0701 micro perforations
- max. 750 m² with Rg 0501 ultramicro perforations

Rectangular panels per week:

- max. 1800 m² unperforated or with Rg 2516 standard perforations
- max. 900 m² with Rd 1522 micro perforations
- max. 900 m² with Rg 0701 micro perforations

Can quotas be pooled?

Yes, but only within the quota quantities per week. topspeed quotas cannot however be cumulated over several weeks.

What is the charge for topspeed service?

We only apply a surcharge of 10% for the topspeed service which entails immediate processing and shortened lead times.



topspeed

Contact

Armstrong Metalldecken AG
 Kunklerstrasse 9
 CH-9015 St. Gallen
 Tel. +41 (0) 71 313 63 63
 Fax +41 (0) 71 313 64 00
 info@gema-ceilings.com
 www.gema-ceilings.com

Armstrong Metalldecken GmbH
 Bundesstrasse 70
 A-6870 Rankweil
 Tel. +43 (0) 55 22 34 44-0
 Fax +43 (0) 55 22 34 44-8

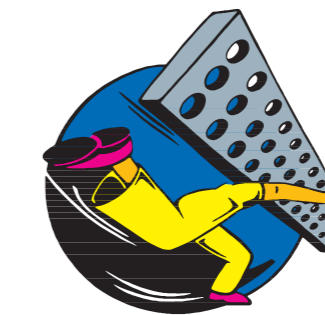

topspeed

Delivered rapidly: Ceilings at topspeed.

It's good to know – that when speed is of the essence, there's now no reason to hit the ceiling. Because Armstrong will do its utmost to deliver your request with topspeed.

topspeed product list

Restricted to the range on the following three inside pages

topspeed hotline

Call, inquire about quotas, and place your order

topspeed orders

Received at the latest by Thursday morning, 9.00 hrs CET

topspeed deliveries

Ex-works no later than Friday of the following week

topspeed service guarantee

For all products on the topspeed product list

topspeed advantage

Production within five working days

At a glance: the topspeed range.

Q-Clip

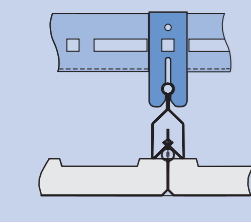

Q-Clip Clip-in System

System	Size	Perforation	Colour	Inlay	topspeed item no.	Min. order quantity in pieces*
Q-Clip	600 x 600	Unperforated	RAL 9010	-	100.100T	1260
Q-Clip	600 x 600	Rg 0501	RAL 9010	-	100.105T	400
Q-Clip	600 x 600	Rg 0701	RAL 9010	VLS	100.106T	400
Q-Clip	600 x 600	Rd 1522	RAL 9010	VLS	100.005T	400
Q-Clip	600 x 600	Rd 1522	RAL 9006	VLS	100.211T	400
Q-Clip	600 x 600	Rd 1522 p.b.	RAL 9010	VLS	100.213T	400
Q-Clip	600 x 600	Rd 1522 p.b.	RAL 9006	VLS	100.215T	400
Q-Clip	625 x 625	Unperforated	RAL 9010	-	100.102T	1512
Q-Clip	625 x 625	Rg 0501	RAL 9010	-	100.104T	700
Q-Clip	625 x 625	Rg 0701	RAL 9010	VLS	100.107T	1000
Q-Clip	625 x 625	Rd 1522	RAL 9010	VLS	100.070T	1260
Q-Clip	625 x 625	Rd 1522	RAL 9006	VLS	100.218T	400
Q-Clip	625 x 625	Rd 1522 p.b.	RAL 9010	VLS	100.220T	400
Q-Clip	625 x 625	Rd 1522 p.b.	RAL 9006	VLS	100.222T	400
Q-Clip	625 x 625	Rg 2516	RAL 9010	VLS	100.103T	1512

Q-L 107

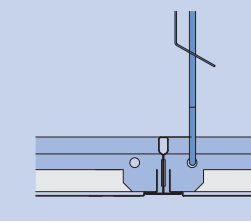

Q-L 107 Lay-in System

System	Size	Perforation	Colour	Inlay	topspeed item no.	Min. order quantity in pieces*
Q-L 107	592 x 592	Rd 1522	RAL 9010	-	100.048T	500
Q-L 107	592 x 592	Rd 1522	RAL 9010	VLS	100.049T	500
Q-L 107	592 x 592	Rg 2516	RAL 9010	-	100.046T	500
Q-L 107	592 x 592	Rg 2516	RAL 9010	VLS	100.047T	1000

R-H 200

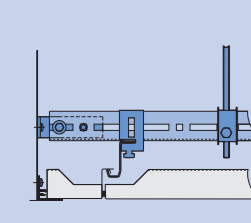

R-H 200 Hook-on System

System	Size	Perforation	Colour	Inlay	topspeed item no.	Min. order quantity in pieces*
R-H 200	1800 x 400	Unperforated	RAL 9010	-	200.031T	200
R-H 200	1800 x 400	Rg 0701	RAL 9010	VLS	200.200T	100
R-H 200	1800 x 400	Rd 1522	RAL 9010	-	200.093T	100
R-H 200	1800 x 400	Rd 1522	RAL 9010	VLS	200.036T	200
R-H 200	1800 x 400	Rd 1522 p.b.	RAL 9010	-	200.206T	100
R-H 200	1800 x 400	Rd 1522 p.b.	RAL 9010	VLS	200.204T	100
R-H 200	1800 x 400	Rg 2516	RAL 9010	-	200.088T	100
R-H 200	1800 x 400	Rg 2516	RAL 9010	VLS	200.041T	200
R-H 200	2100 x 400	Unperforated	RAL 9010	-	200.032T	200
R-H 200	2100 x 400	Rg 0701	RAL 9010	VLS	200.214T	100
R-H 200	2100 x 400	Rd 1522	RAL 9010	-	200.094T	100
R-H 200	2100 x 400	Rd 1522	RAL 9010	VLS	200.037T	200
R-H 200	2100 x 400	Rd 1522 p.b.	RAL 9010	-	200.212T	100
R-H 200	2100 x 400	Rd 1522 p.b.	RAL 9010	VLS	200.210T	100
R-H 200	2100 x 400	Rg 2516	RAL 9010	-	200.089T	100
R-H 200	2100 x 400	Rg 2516	RAL 9010	VLS	200.042T	200

p.b.: perforated border

*Smaller order quantities sometimes available ex stock. Please get in touch with us.

R-H 215

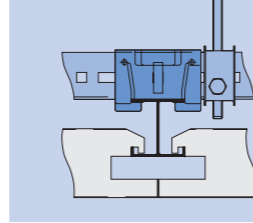

System	Size	Perforation	Colour	Inlay	topspeed item no.	Min. order quantity in pieces*
R-H 200	2400 x 400	Unperforated	RAL 9010	-	200.033T	200
R-H 200	2400 x 400	Rg 0701	RAL 9010	VLS	200.224T	100
R-H 200	2400 x 400	Rd 1522	RAL 9010	-	200.097T	100
R-H 200	2400 x 400	Rd 1522	RAL 9010	VLS	200.038T	200
R-H 200	2400 x 400	Rd 1522 p.b.	RAL 9010	-	200.222T	100
R-H 200	2400 x 400	Rd 1522 p.b.	RAL 9010	VLS	200.220T	100
R-H 200	2400 x 400	Rg 2516	RAL 9010	-	200.090T	100
R-H 200	2400 x 400	Rg 2516	RAL 9010	VLS	200.043T	200
R-H 200	2700 x 400	Unperforated	RAL 9010	-	200.034T	100
R-H 200	2700 x 400	Rg 0701	RAL 9010	VLS	200.234T	100
R-H 200	2700 x 400	Rd 1522	RAL 9010	-	200.095T	100
R-H 200	2700 x 400	Rd 1522	RAL 9010	VLS	200.039T	100
R-H 200	2700 x 400	Rd 1522 p.b.	RAL 9010	-	200.232T	100
R-H 200	2700 x 400	Rd 1522 p.b.	RAL 9010	VLS	200.230T	100
R-H 200	2700 x 400	Rg 2516	RAL 9010	-	200.091T	100
R-H 200	2700 x 400	Rg 2516	RAL 9010	VLS	200.044T	200
R-H 200	3000 x 400	Unperforated	RAL 9010	-	200.035T	100
R-H 200	3000 x 400	Rg 0701	RAL 9010	VLS	200.244T	100
R-H 200	3000 x 400	Rd 1522	RAL 9010	-	200.096T	100
R-H 200	3000 x 400	Rd 1522	RAL 9010	VLS	200.040T	100
R-H 200	3000 x 400	Rd 1522 p.b.	RAL 9010	-	200.242T	100
R-H 200	3000 x 400	Rd 1522 p.b.	RAL 9010	VLS	200.240T	100
R-H 200	3000 x 400	Rg 2516	RAL 9010	-	200.092T	100
R-H 200	3000 x 400	Rg 2516	RAL 9010	VLS	200.045T	100
R-H 215	1800 x 400	Unperforated	RAL 9010	-	201.025T	200
R-H 215	1800 x 400	Rg 0701	RAL 9010	VLS	201.100T	100
R-H 215	1800 x 400	Rd 1522	RAL 9010	-	201.028T	100
R-H 215	1800 x 400	Rd 1522	RAL 9010	VLS	201.026T	200
R-H 215	1800 x 400	Rd 1522 p.b.	RAL 9010	-	201.106T	100
R-H 215	1800 x 400	Rd 1522 p.b.	RAL 9010	VLS	201.104T	100
R-H 215	1800 x 400	Rg 2516	RAL 9010	-	201.029T	100
R-H 215	1800 x 400	Rg 2516	RAL 9010	VLS	201.027T	200
R-H 215	2100 x 400	Unperforated	RAL 9010	-	201.030T	200
R-H 215	2100 x 400	Rg 0701	RAL 9010	VLS	201.114T	100
R-H 215	2100 x 400	Rd 1522	RAL 9010	-	201.033T	100
R-H 215	2100 x 400	Rd 1522	RAL 9010	VLS	201.031T	200
R-H 215	2100 x 400	Rd 1522 p.b.	RAL 9010	-	201.112T	100
R-H 215	2100 x 400	Rd 1522 p.b.	RAL 9010	VLS	201.110T	100
R-H 215	2100 x 400	Rg 2516	RAL 9010	-	201.034T	100
R-H 215	2100 x 400	Rg 2516	RAL 9010	VLS	201.032T	200
R-H 215	2400 x 400	Unperforated	RAL 9010	-	201.035T	200
R-H 215	2400 x 400	Rg 0701	RAL 9010	VLS	201.124T	100
R-H 215	2400 x 400	Rd 1522	RAL 9010	-	201.038T	100
R-H 215	2400 x 400	Rd 1522	RAL 9010	VLS	201.036T	200
R-H 215	2400 x 400	Rd 1522 p.b.	RAL 9010	-	201.122T	100

p.b.: perforated border

*Smaller order quantities sometimes available ex stock. Please get in touch with us.

System	Size	Perforation	Colour	Inlay	topspeed item no.	Min. order quantity in pieces*
R-H 215	2400 x 400	Rd 1522 p.b.	RAL 9010	VLS	201.120T	100
R-H 215	2400 x 400	Rg 2516	RAL 9010	-	201.039T	100
R-H 215	2400 x 400	Rg 2516	RAL 9010	VLS	201.037T	200
R-H 215	2700 x 400	Unperforated	RAL 9010	-	201.040T	100
R-H 215	2700 x 400	Rg 0701	RAL 9010	VLS	201.134T	100
R-H 215	2700 x 400	Rd 1522	RAL 9010	-	201.043T	100
R-H 215	2700 x 400	Rd 1522	RAL 9010	VLS	201.041T	100
R-H 215	2700 x 400	Rd 1522 p.b.	RAL 9010	-	201.132T	100
R-H 215	2700 x 400	Rd 1522 p.b.	RAL 9010	VLS	201.130T	100
R-H 215	2700 x 400	Rg 2516	RAL 9010	-	201.044T	100
R-H 215	2700 x 400	Rg 2516	RAL 9010	VLS	201.042T	100
R-H 215	3000 x 400	Unperforated	RAL 9010	-	201.045T	100
R-H 215	3000 x 400	Rg 0701	RAL 9010	VLS	201.144T	100
R-H 215	3000 x 400	Rd 1522	RAL 9010	-	201.048T	100
R-H 215	3000 x 400	Rd 1522	RAL 9010	VLS	201.046T	100
R-H 215	3000 x 400	Rd 1522 p.b.	RAL 9010	-	201.142T	100
R-H 215	3000 x 400	Rd 1522 p.b.	RAL 9010	VLS	201.140T	100
R-H 215	3000 x 400	Rg 2516	RAL 9010	-	201.049T	100
R-H 215	3000 x 400	Rg 2516	RAL 9010	VLS	201.047T	100
R-H-215	1800 x 300	Unperforated	RAL 9010	-	201.000T	100
R-H-215	1800 x 300	Rg 0701	RAL 9010	VLS	201.050T	100
R-H-215	1800 x 300	Rd 1522	RAL 9010	-	201.003T	100
R-H-215	1800 x 300	Rd 1522	RAL 9010	VLS	201.001T	100
R-H-215	1800 x 300	Rg 2516	RAL 9010	-	201.004T	100
R-H-215	1800 x 300	Rg 2516	RAL 9010	VLS	201.002T	100
R-H-215	2100 x 300	Unperforated	RAL 9010	-	201.005T	100
R-H-215	2100 x 300	Rg 0701	RAL 9010	VLS	201.051T	100
R-H-215	2100 x 300	Rd 1522	RAL 9010	-	201.008T	100
R-H-215	2100 x 300	Rd 1522	RAL 9010	VLS	201.006T	100
R-H-215	2100 x 300	Rg 2516	RAL 9010	-	201.009T	100
R-H-215	2100 x 300	Rg 2516	RAL 9010	VLS	201.007T	100
R-H-215	2400 x 300	Unperforated	RAL 9010	-	201.010T	100
R-H-215	2400 x 300	Rg 0701	RAL 9010	VLS	201.052T	100
R-H-215	2400 x 300	Rd 1522	RAL 9010	-	201.013T	100
R-H-215	2400 x 300	Rd 1522	RAL 9010	VLS	201.011T	100
R-H-215	2400 x 300	Rg 2516	RAL 9010	-	201.014T	100
R-H-215	2400 x 300	Rg 2516	RAL 9010	VLS	201.012T	100
R-H-215	2700 x 300	Unperforated	RAL 9010	-	201.015T	100
R-H-215	2700 x 300	Rg 0701	RAL 9010	VLS	201.053T	100
R-H-215	2700 x 300	Rd 1522	RAL 9010	-	201.018T	100
R-H-215	2700 x 300	Rd 1522	RAL 9010	VLS	201.016T	100
R-H-215	2700 x 300	Rg 2516	RAL 9010	-	201.019T	100
R-H-215	2700 x 300	Rg 2516	RAL 9010	VLS	201.017T	100
R-H-215	3000 x 300	Unperforated	RAL 9010	-	201.020T	100
R-H-215	3000 x 300	Rg 0701	RAL 9010	VLS	201.054T	100
R-H-215	3000 x 300	Rd 1522	RAL 9010	-	201.023T	100
R-H-215	3000 x 300	Rd 1522	RAL 9010	VLS	201.021T	100
R-H-215	3000 x 300	Rg 2516	RAL 9010	-	201.024T	100
R-H-215	3000 x 300	Rg 2516	RAL 9010	VLS	201.022T	100

p.b.: perforated border

*Smaller order quantities sometimes available ex stock. Please get in touch with us.